

PARKING STALL COUNT		
TYPE OF STALL	SYMBOL	NUMBER OF STALLS
FACILITIES MANAGEMENT PARKING	(FM)	2
HANDICAPPED	(♿)	6
HANDICAPPED - VAN ACCESSIBLE	(♿) VAN	3
STATE VEHICLES	(S)	2
COLLEGE OF AG PARKING	(CA)	1
TOTAL		14

LASSEN HALL

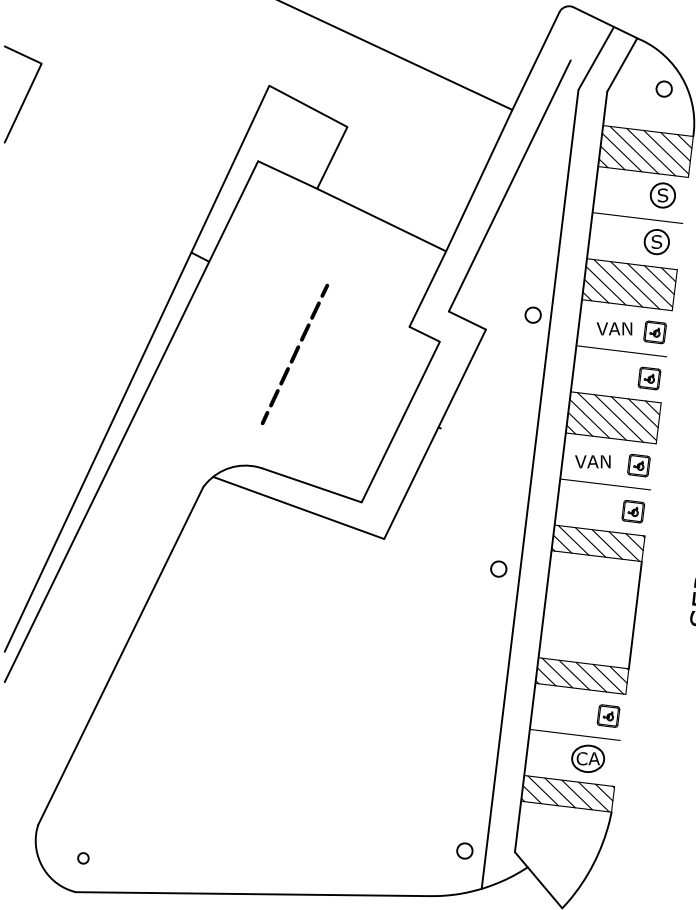

SERVICE ROAD/FIRE LANE

SERVICE ROAD/FIRE LANE

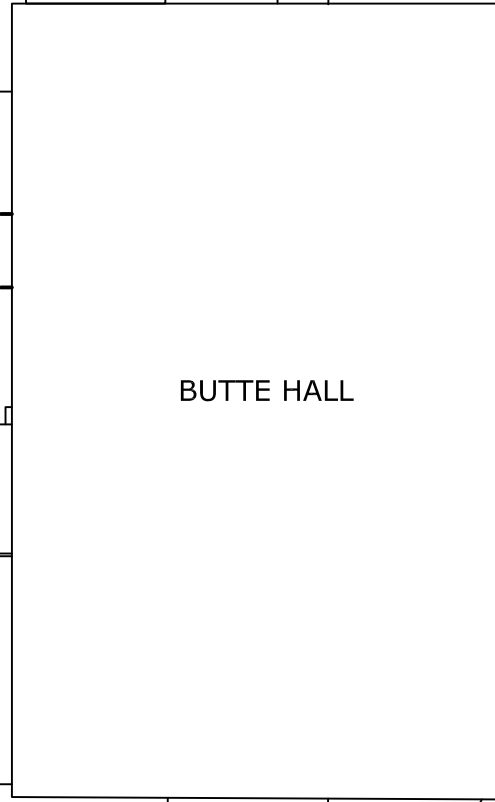

BUTTE HALL



Scale: 1"=40'